

# TOOWONG VILLAGE

LOVE THE VILLAGE



**Toowong Village** is an inner-city shopping centre and commercial office tower, located just 3 kilometres from the Brisbane CBD. The property was redeveloped in 2022, with the vertical transport upgraded and the addition of Woolworths, TK Maxx, Hanaromart and many new retailers.

Sitting above the third busiest train station in Brisbane, Toowong Village is a modern shopping environment built for convenience. The centre is highly accessible by public transport, and in close proximity to University of Queensland, St Lucia campus.

## AGE PROFILE

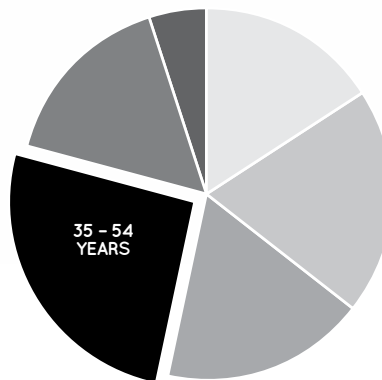

0 - 14 YEARS	16%
15 - 24 YEARS	21%
25 - 34 YEARS	16%
35 - 54 YEARS	26%
55 - 74 YEARS	16%
75 + YEARS	5%

## KEY FEATURES

86

NUMBER OF  
RETAILERS

250m

TOTAL ANNUAL SALES (\$)

31,882

GROSS LEASABLE  
AREA (M2)

1,576

CAR PARKS

7.0m

ANNUAL CUSTOMER VISITS

## MAJORS

- COLES
- KMART
- WOOLWORTHS

## DEMOGRAPHICS

AFFLUENT  
MATURE FAMILIES,  
YOUNG PROFESSIONALS

MARKET

139,374

TRADE AREA POPULATION

# TOOWONG VILLAGE

LOVE THE VILLAGE

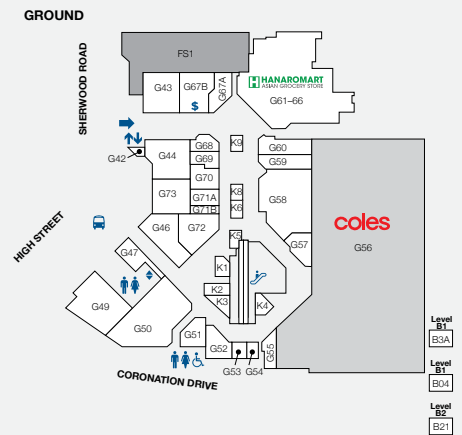
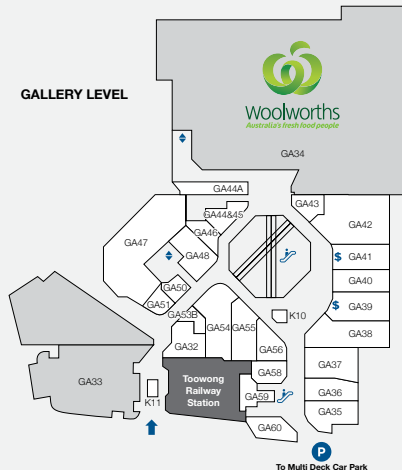
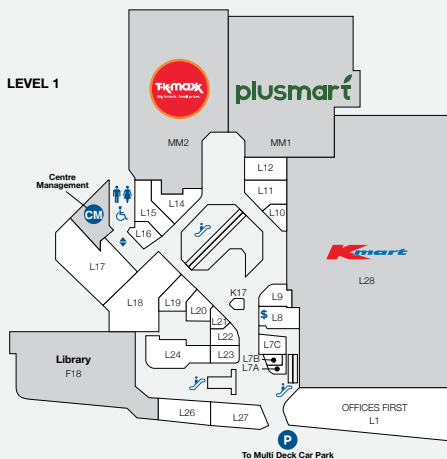

STORE	LEVEL	STORE NO	STORE	LEVEL	STORE NO	STORE	LEVEL	STORE NO
<b>MAJORS</b>			Yi Fang Fruit Tea	Gallery	GA51	<b>LIQUOR</b>		
Coles	Ground	G56	Zhang Liang Malatang	Ground	G47	BWS	Gallery	GA34
Kmart	Level 1	L28	<b>FASHION</b>			Liquorland	Gallery	GA32
Woolworths	Gallery	GA34	Juniper & Co	Gallery	GA54	Vintage Cellars	Basement 1	B04
<b>MINI MAJORS</b>			Sportsgirl	Gallery	GA37	<b>MEDICAL &amp; OPTOMETRISTS</b>		
Plusmart	Level 1	MM1	Sussan	Gallery	GA38	First Choice Chiropractic	Gallery	GA60
TK Maxx	Level 1	MM2	<b>FLORIST</b>			My Dentist Australia	Level 1	L11
<b>BANKS</b>			Daisy's Florist	Gallery	GA59	MyHealth Medical Centre (Sullivan Nicolaides)	Level 1	L17
ANZ	Gallery	GA41	<b>FRESH FOOD</b>			OPSM	Gallery	GA36
CBA	Ground	G67B	Bakers Delight	Ground	G70	Priceline Pharmacy	Level 1	L18
NAB	Gallery	GA39	Fruity Capers & Deli	Ground	G58	Specsavers	Level 1	L15
<b>FOOD EAT IN/AWAY</b>			Hanaromart	Ground	G61-66	Terry White Chemmart (QML Pathology)	Ground	G50
Ambassador Specialty Coffee	Ground	K1	Health Squared Go Vita	Ground	G60	Toowong Village Dental	Level 2	
Boost Juice	Ground	G57	The Source Bulk Foods	Gallery	GA46	<b>NEWSAGENCY</b>		
Chatime	Ground	K2	Toowong Deli	Gallery	GA44&45	Nextra Toowong	Ground	G72
Chatterbox Café	Level 1	L20	Toowong Village Meats	Ground	G59	<b>SERVICES</b>		
G Free Donuts	Ground	G71B	<b>GAMES &amp; ELECTRONICS</b>			Catch Wonderland	Gallery	GA50
GU Dessert	Ground	K3	EB Games	Level 1	L9	Centre Management	Level 1	CM
ISPA Kebabs	Ground	G71A	<b>HEALTH &amp; BEAUTY</b>			Crown Currency Exchange	Gallery	GA53B
Lucky Chopsticks	Ground	G67A	Fashion Nail Bar	Level 1	L23	Flight Centre	Ground	G51
Merlo Coffee	Ground	K4	Footcare Haven	Level 1	L16	Footwear Fixers	Level 1	L21
Mr Curry	Ground	G68	Freesia Salon	Level 1	L7C	Goodlife Health Club	Level 2	
Orange Tea	Ground	K9	Health First Massage & Acupuncture	Level 1	L26	Mister Minit	Ground	G54
Paris Play Cafe	Gallery	GA44A	Laser Clinics Australia	Gallery	GA56	Offices First (serviced offices)	Level 1	L1
Rollin's	Ground	G69	Polish Nail Lounge	Level 1	L14	Sparkles Auto Care	Basement 1	B3A
Rolling Man	Ground	K08	Shehnaz Beauty	Level 1	L10	Toowong Library	Level 1	F18
Sushi Hub	Gallery	GA48	S+S Hair.Beauty	Level 1	L19	Toowong Tobacco	Ground	G42
Sushi Paradise	Ground	K6	Stefan	Gallery	GA55	<b>MOBILES &amp; ACCESSORIES</b>		
Sweet Pastry & Cake	Ground	K5	T&T Barber Shop	Ground	G55	Casphone	Ground	G53
Toowong Deli	Gallery	GA44&45	T-Cut	Basement 2	B21	JSL Tech Sales & Repairs	Level 1	L22
<b>HIGH ST EAT</b>			<b>HOMEWARES &amp; GIFTS</b>			Telstra Shop	Gallery	GA40
Grill'd	Ground	G44	Bed Bath 'n Table	Gallery	GA42	The Case Station	Gallery	K10
Guzman Y Gomez	Ground	G43	Kingdom Gifts	Level 1	L21	Vodafone	Gallery	GA43
Nando's	Ground	G49	Robins Kitchen	Ground	G52	*Yes* Optus	Gallery	GA58
Queens Bapsang	Ground	G73	The Total Picture Framing Co.	Level 1	L27			

## LEASING ENQUIRIES

### NATHAN BUTLER

YFG Portfolio Leasing Executive  
P 0413 200 031

E nathan.butler@retailfirst.com.au

### ANTHONY CAPIAGHI

YFG Portfolio Leasing Executive  
P 0413 200 021

E anthony.capiaghi@retailfirst.com.au

### KERRI JONES Senior Centre Manager

Toowong Village & Tower  
P 0413 200 016

E kjones@retailfirst.com.au

Retail First

9 SHERWOOD RD, TOOWONG QLD 4066 | P (07) 3870 7177  
TOOWONGVILLAGE@RETAILFIRST.COM.AU | WWW.TOOWONGVILLAGE.COM.AU

**Disclaimer:** The shopping centre described in this publication is managed by Retail First Pty Ltd. Whilst all reasonable efforts have been made to ensure the information in this publication is accurate and up to date, Retail First maintains the right to update or change the information at any time, without notice to users. Retail First does not warrant the content or accuracy of the information in this publication, including information sourced from third parties, and does not guarantee that any forward looking statement, image, artist impression, or forecast in this publication will actually occur. Retail First has taken all reasonable care when preparing this publication but accepts no liability from the use or reliance of the information. This publication was created in June 2025. ABS Census data 2016.

