

TOOWONG VILLAGE

LOVE THE VILLAGE



Toowong Village is an inner-city shopping centre and commercial office tower, located just 3 kilometres from the Brisbane CBD. The property was redeveloped in 2022, with the vertical transport upgraded and the addition of Woolworths, TK Maxx, Hanaromart and many new retailers.

Sitting above the third busiest train station in Brisbane, Toowong Village is a modern shopping environment built for convenience. The centre is highly accessible by public transport, and in close proximity to University of Queensland, St Lucia campus.

AGE PROFILE

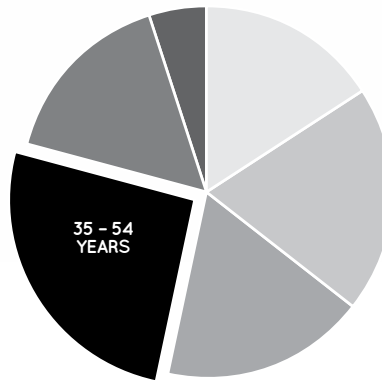

0 - 14 YEARS	16%
15 - 24 YEARS	21%
25 - 34 YEARS	16%
35 - 54 YEARS	26%
55 - 74 YEARS	16%
75 + YEARS	5%

KEY FEATURES

86

NUMBER OF RETAILERS

250m

TOTAL ANNUAL SALES (\$)

31,882

GROSS LEASABLE AREA (M2)

1,576

CAR PARKS

7.0m

ANNUAL CUSTOMER VISITS

MAJORS

- COLES
- KMART
- WOOLWORTHS

DEMOGRAPHICS

AFFLUENT MATURE FAMILIES, YOUNG PROFESSIONALS

MARKET

139,374

TRADE AREA POPULATION

TOOWONG VILLAGE

LOVE THE VILLAGE

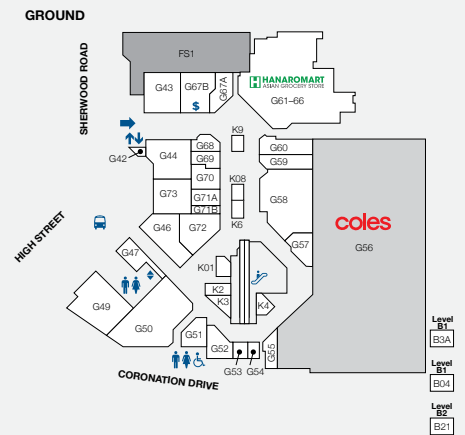
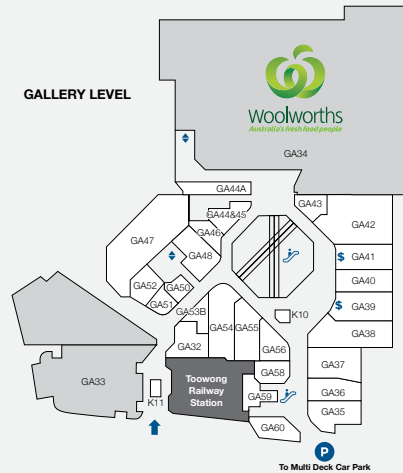

STORE	LEVEL	STORE NO	STORE	LEVEL	STORE NO	STORE	LEVEL	STORE NO
MAJORS			FASHION			LIQUOR		
Coles	Ground	G56	Juniper & Co	Gallery	GA54	BWS	Gallery	GA34
Kmart	Level 1	L28	Moda Eleganta	Gallery	GA55	Liquorland	Gallery	GA32
Woolworths	Gallery	GA34	Sportsgirl	Gallery	GA37	Vintage Cellars	Basement 1	B04
MINI MAJORS			Sussan	Gallery	GA38	MEDICAL & OPTOMETRISTS		
TK Maxx	Level 1	MM2	FLORIST			First Choice Chiropractic	Gallery	GA60
BANKS			Daisy's Florist	Gallery	GA59	My Dentist Australia	Level 1	L11
ANZ	Gallery	GA41	FRESH FOOD			MyHealth Medical Centre (Sullivan Nicolaides)	Level 1	L17
BOQ	Level 1	L8	Bakers Delight	Ground	G70	OPSM	Gallery	GA36
CBA	Ground	G67B	Fruity Capers & Deli	Ground	G58	Specsavers	Level 1	L15
NAB	Gallery	GA39	Hanaromart	Ground	G61-66	Terry White Chemmart (QML Pathology)	Ground	G50
FOOD EAT IN/AWAY			Health Squared Go Vita	Ground	G60	Toowong Village Dental	Level 2	
Ambassador Specialty Coffee	Ground	K1	The Source Bulk Foods	Gallery	GA46	NEWSAGENCY		
Bird's Nest on the Run	Ground	G67A	Toowong Deli	Gallery	GA44&45	Nextra Toowong	Ground	G72
Boost Juice	Ground	G57	Toowong Village Meats	Ground	G59	SERVICES		
Chatime	Ground	K2	GAMES & ELECTRONICS			Centre Management	Level 1	CM
Chatterbox Café	Level 1	L20	EB Games	Level 1	L9	Crown Currency Exchange	Level 1	L7B
G Free Donuts	Ground	G71B	HEALTH & BEAUTY			Flight Centre	Ground	G51
GU Dessert	Ground	K3	Fashion Nail Bar	Level 1	L23	Footwear Fixers	Level 1	L21
ISPA Kebabs	Ground	G71A	Footcare Haven	Level 1	L16	Goodlife Health Club	Level 2	
Merlo Coffee	Ground	K4	Freesia Salon	Level 1	L7C	Mister Minit	Ground	G54
Mr Curry	Ground	G68	Health First Massage & Acupuncture	Level 1	L26	Toowong Library	Level 1	F18
Orange Tea	Ground	K9	Laser Clinics Australia	Gallery	GA56	Toowong Tobacco	Ground	G42
Paris Play Cafe	Gallery	GA44A	Polish Nail Lounge	Level 1	L14	MOBILES & ACCESSORIES		
Rollin's	Ground	G69	Shehnaz Beauty	Level 1	L10	Casphone	Ground	G53
Rolling Man	Ground	K08	Stefan	Gallery	GA53B	JSL Tech Sales & Repairs	Level 1	L22
Sushi Hub	Gallery	GA48	S+S Hair.Beauty	Level 1	L19	Telstra Shop	Gallery	GA40
Sushi Paradise	Ground	K6	T&T Barber Shop	Ground	G55	The Case Station	Gallery	K10
Toowong Deli	Gallery	GA44&45	T-Cut	Basement 2	B21	Vodafone	Gallery	GA43
Yi Fang Fruit Tea	Gallery	GA51	HOMEWARES & GIFTS			*Yes* Optus	Gallery	GA58
HIGH ST EAT			Bed Both 'n Table	Gallery	GA42			
Grill'd	Ground	G44	Kaisercraft	Level 1	L18			
Guzman Y Gomez	Ground	G43	Kingdom Gifts	Level 1	L21			
Nando's	Ground	G49	Robins Kitchen	Ground	G52			
Queens Bapsang	Ground	G73	The Total Picture Framing Co.	Level 1	L27			
San Churro	Ground	G46						
Zhang Liang Malatang	Ground	G47						

LEASING ENQUIRIES

SUSIE ROMPIES YFG Leasing Executive
Toowong Village & Tower
M 0434 075 269
E susie.rompies@retailfirst.com.au

KERRI JONES Senior Centre Manager
Toowong Village & Tower
P 0413 200 016
E kjones@retailfirst.com.au



9 SHERWOOD RD, TOOWONG QLD 4066 | P (07) 3870 7177
TOOWONGVILLAGE@RETAILFIRST.COM.AU | WWW.TOOWONGVILLAGE.COM.AU



Disclaimer: The shopping centre described in this publication is managed by Retail First Pty Ltd. Whilst all reasonable efforts have been made to ensure the information in this publication is accurate and up to date, Retail First maintains the right to update or change the information at any time, without notice to users. Retail First does not warrant the content or accuracy of the information in this publication, including information sourced from third parties, and does not guarantee that any forward looking statement, image, artist impression, or forecast in this publication will actually occur. Retail First has taken all reasonable care when preparing this publication but accepts no liability from the use or reliance of the information. This publication was created in October 2024. ABS Census data 2016.