

TOOWONG VILLAGE

LOVE THE VILLAGE



Toowong Village is an inner-city shopping centre and commercial office tower, located just 3 kilometres from the Brisbane CBD. The property was redeveloped in 2022, with the vertical transport upgraded and the addition of Woolworths, TK Maxx, Hanaromart and many new retailers.

Sitting above the third busiest train station in Brisbane, Toowong Village is a modern shopping environment built for convenience. The centre is highly accessible by public transport, and in close proximity to University of Queensland, St Lucia campus.

AGE PROFILE

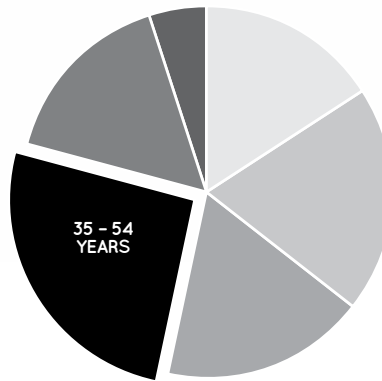

0 - 14 YEARS	16%
15 - 24 YEARS	21%
25 - 34 YEARS	16%
35 - 54 YEARS	26%
55 - 74 YEARS	16%
75 + YEARS	5%

KEY FEATURES

81

NUMBER OF RETAILERS

180m

TOTAL ANNUAL SALES (\$)

31,747

GROSS LEASABLE AREA (M2)

1,576

CAR PARKS

5.5m

ANNUAL CUSTOMER VISITS

MAJORS

- COLES
- KMART
- WOOLWORTHS

DEMOGRAPHICS

AFFLUENT MATURE FAMILIES, YOUNG PROFESSIONALS

MARKET

146,100

TRADE AREA POPULATION

TOOWONG VILLAGE

LOVE THE VILLAGE

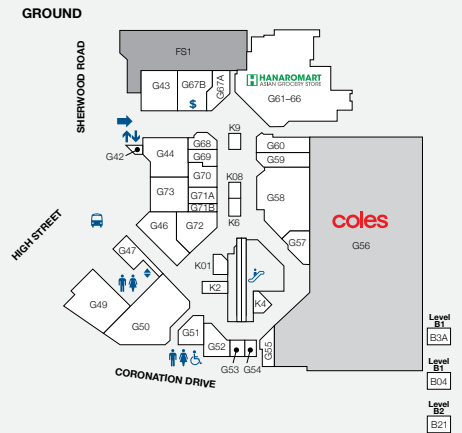
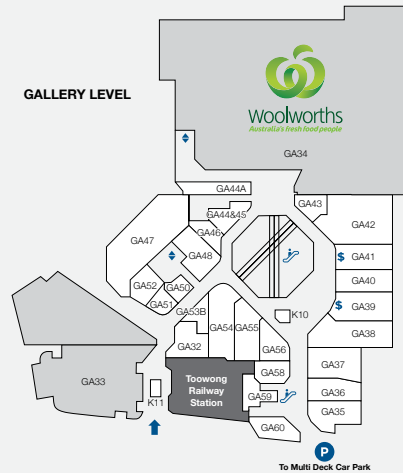

STORE	LEVEL	STORE NO	STORE	LEVEL	STORE NO	STORE	LEVEL	STORE NO
MAJORS			FASHION			LIQUOR		
Coles	Ground	G56	Juniper & Co	Gallery	GA54	BWS	Gallery	GA34
Kmart	Level 1	L28	Moda Eleganza	Gallery	GA55	Liquorland	Gallery	GA32
Woolworths	Gallery	GA34	Sportsgirl	Gallery	GA37	Vintage Cellars	Basement 1	B04
MINI MAJORS			Sussan	Gallery	GA38	MEDICAL & OPTOMETRISTS		
Fresco Asian Supermarket	Level 1	MM1	FLORIST			First Choice Chiropractic	Gallery	GA60
TK Maxx	Level 1	MM2	Daisy's Florist	Gallery	GA59	My Dentist Australia	Level 1	L11
BANKS			FRESH FOOD			MyHealth Medical Centre (Sullivan Nicolaides)	Level 1	L17
ANZ	Gallery	GA41	Bakers Delight	Ground	G70	OPSM	Gallery	GA36
BOQ	Level 1	L8	Fruity Capers & Deli	Ground	G58	Specsavers	Level 1	L15
CBA	Ground	G67B	Hanaromart	Ground	G61-66	Terry White Chemmart (QML Pathology)	Ground	G50
NAB	Gallery	GA39	Health Squared Go Vita	Ground	G60	Toowong Village Dental	Level 2	
FOOD EAT IN/AWAY			The Source Bulk Foods	Gallery	GA46	NEWSAGENCY		
Ambassador Specialty Coffee	Ground	K1	Toowong Deli	Gallery	GA44&45	Nextra Toowong	Ground	G72
Bird's Nest on the Run	Ground	G67A	Toowong Village Meats	Ground	G59	SERVICES		
Boost Juice	Ground	G57	GAMES & ELECTRONICS			All Way Travel	Gallery	GA50
Chatime	Ground	K2	EB Games	Level 1	L9	Centre Management	Level 1	CM
Chatterbox Café	Level 1	L20	HEALTH & BEAUTY			Crown Currency Exchange	Level 1	L7B
G Free Donuts	Ground	G71B	Fashion Nail Bar	Level 1	L23	Flight Centre	Ground	G51
Merlo Coffee	Ground	K4	Footcare Haven	Level 1	L16	Footwear Fixers	Level 1	L21
Mr Curry	Ground	G68	Health First Massage & Acupuncture	Level 1	L26	Goodlife Health Club	Level 2	
Orange Tea	Ground	K9	Laser Clinics Australia	Gallery	GA56	Mister Minit	Ground	G54
Paris Play Cafe	Gallery	GA44A	Polish Nail Lounge	Level 1	L14	Offices First (serviced offices)	Level 1	L1
Rollin's	Ground	G69	Shehnaz Beauty	Level 1	L10	Sparkles Auto Care	Basement 1	B3A
Rolling Man	Ground	K08	Stefan	Gallery	GA53B	Toowong Library	Level 1	F18
Sushi Hub	Gallery	GA48	S+S Hair.Beauty	Level 1	L19	Toowong Tobacco	Ground	G42
Sushi Paradise	Ground	K6	T&T Barber Shop	Ground	G55	MOBILES & ACCESSORIES		
Toowong Deli	Gallery	GA44&45	V8 Supercuts	Basement 2	B21	Casphone	Ground	G53
Yi Fang Fruit Tea	Gallery	GA51	HOMEWARES & GIFTS			JSL Tech Sales & Repairs	Level 1	L22
HIGH ST EAT			Bed Bath 'n Table	Gallery	GA42	Telstra Shop	Gallery	GA40
Grill'd	Ground	G44	Kaisercraft	Level 1	L18	The Case Station	Gallery	K10
Guzman Y Gomez	Ground	G43	Kingdom Gifts	Level 1	L21	Vodafone	Gallery	GA43
KBQ (Korean BBQ)	Ground	G73	Robins Kitchen	Ground	G52	'Yes' Optus	Gallery	GA58
Nando's	Ground	G49	The Total Picture Framing Co.	Level 1	L27			
San Churro	Ground	G46						

LEASING ENQUIRIES

CHRIS ALCOCK YFG Portfolio Leasing Manager
 Toowong Village & Tower
 P 3323 8888 | M 0401 237 817
 E chris.alcock@retailfirst.com.au

KERRI JONES Centre Manager
 Toowong Village & Tower
 P 07 3870 7177
 E kjones@retailfirst.com.au



9 SHERWOOD RD, TOOWONG QLD 4066 | P (07) 3870 7177
 TOOWONGVILLAGE@RETAILFIRST.COM.AU | WWW.TOOWONGVILLAGE.COM.AU



Disclaimer: The shopping centre described in this publication is managed by Retail First Pty Ltd. Whilst all reasonable efforts have been made to ensure the information in this publication is accurate and up to date, Retail First maintains the right to update or change the information at any time, without notice to users. Retail First does not warrant the content or accuracy of the information in this publication, including information sourced from third parties, and does not guarantee that any forward looking statement, image, artist impression, or forecast in this publication will actually occur. Retail First has taken all reasonable care when preparing this publication but accepts no liability from the use or reliance of the information. This publication was created in March 2023. ABS Census data 2016.