

# TOOWONG VILLAGE

LOVE THE VILLAGE



**Toowong Village** is an inner-city shopping centre and commercial office tower, located just 3 kilometres from the Brisbane CBD. The entire property was completely refurbished by July 2015, with a new alfresco dining precinct added.

Sitting above the third busiest train station in Brisbane, Toowong Village is a modern shopping environment built for convenience. The centre is highly accessible by public transport, and in close proximity to University of Queensland, St Lucia campus.

## AGE PROFILE

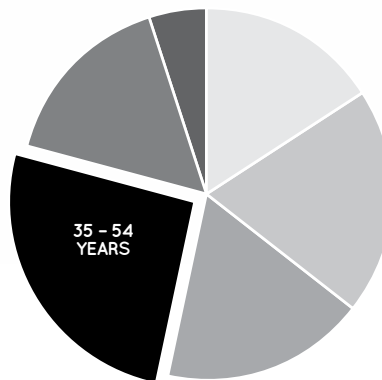

0 - 14 YEARS	16%
15 - 24 YEARS	21%
25 - 34 YEARS	16%
35 - 54 YEARS	26%
55 - 74 YEARS	16%
75 + YEARS	5%

## KEY FEATURES

78

NUMBER OF RETAILERS

171m

TOTAL ANNUAL SALES (\$)

31,469

GROSS LEASABLE AREA (M2)

1,576

CAR PARKS

7.3m

ANNUAL CUSTOMER VISITS

## MAJORS

- COLES
- KMART

## DEMOGRAPHICS

AFFLUENT  
MATURE FAMILIES,  
YOUNG PROFESSIONALS

MARKET

146,100

TRADE AREA POPULATION

# TOOWONG VILLAGE

LOVE THE VILLAGE

LEVEL 1



GALLERY LEVEL

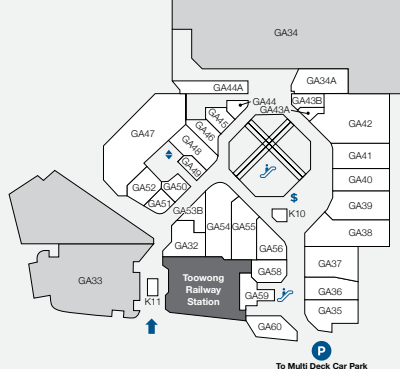

GROUND

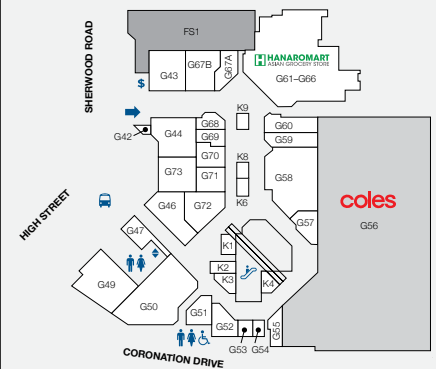

STORE	LEVEL	STORE NO	STORE	LEVEL	STORE NO	STORE	LEVEL	STORE NO
<b>MAJORS</b>			<b>FLORIST</b>			<b>MEDICAL &amp; OPTOMETRISTS</b>		
Coles	Ground	G56	Daisy's Florist	Gallery	GA59	First Choice Chiropractic	Gallery	GA60
Kmart	Level 1	L28	<b>FRESH FOOD</b>			My Dentist Australia	Level 1	L11
<b>BANKS</b>			Bakers Delight	Ground	G70	MyHealth Medical Centre		
BOQ	Level 1	L8	Fruity Capers & Deli	Ground	G58	(Sullivan Nicolaides)	Level 1	L17
CBA	Ground	G67B	Hanaromart	Ground	G61	OPSM	Gallery	GA36
NAB	Gallery	GA39	Health Squared	Ground	G60	Specsavers	Level 1	L15
<b>FOOD EAT IN/AWAY</b>			Village Meats	Ground	G59	Terry White Chemmart	Ground	G50
Ambassador Specialty Coffee	Ground	K1	<b>GAMES &amp; ELECTRONICS</b>			Toowong Village Dental	Level 2	
Bird's Nest on the Run	Ground	G67A	EB Games	Level 1	L9	<b>NEWSAGENCY</b>		
Boost Juice	Ground	G57	<b>HEALTH &amp; BEAUTY</b>			Nextra Toowong	Ground	G72
Chatterbox Café	Level 1	L20	Fashion Nail Bar	Level 1	L23	<b>SERVICES</b>		
Chatime	Ground	K2	Footcare Haven	Level 1	L16	All Way Travel	Gallery	GA50
Merlo Coffee	Ground	K4	Health First Massage & Acupuncture	Level 1	L26	Crown Currency Exchange	Level 1	L7B
Mr Curry	Ground	G68	Laser Clinics Australia	Gallery	GA56	Flight Centre	Ground	G51
Orange Tea	Ground	K9	Polish Nail Lounge	Level 1	L14	Footwear Fixers	Level 1	L7A
Roast & Toast	Ground	G71	Shehnaz Beauty	Level 1	L10	Goodlife Health Club	Level 2	
Rollin's	Ground	G69	Stefan	Gallery	GA53B	Mister Minit	Ground	G54
Rolling Man	Ground	K8	S+S Hair.Beauty	Level 1	L19	Sparkles Auto Care	Basement 1	B3A
Sushi Paradise	Ground	K6	T&T Barber Shop	Level 1	L7C	Toowong Library	Level 1	F18
<b>HIGH ST EAT</b>			V8 Supercuts	Gallery	GA51	Toowong Tobacco	Ground	G42
Grill'd	Ground	G44	<b>HOMEWARES &amp; GIFTS</b>			<b>MOBILES &amp; ACCESSORIES</b>		
Guzman Y Gomez	Ground	G43	Bed Bath 'n Table	Gallery	GA42	Casphone	Ground	G53
Nando's	Ground	G49	Kaisercraft	Level 1	L18	JSL Tech Sales & Repairs	Level 1	L22
San Churro	Ground	G46	Kingdom Gifts	Level 1	L7A	Telstra Shop	Gallery	GA40
Stellarossa	Ground	G47	Robins Kitchen	Ground	G52	The Case Station	Gallery	K10
Tibetan Kitchen	Ground	G73	The Total Picture Framing Co.	Level 1	L27	*Yes* Optus	Gallery	GA58
<b>FASHION</b>			<b>LIQUOR</b>					
Juniper & Co	Gallery	GA54	Liquorland	Gallery	GA32			
Moda Eleganta	Gallery	GA55	Vintage Cellars	Basement 1	B04			
Sportsgirl	Gallery	GA37						
Sussan	Gallery	GA38						

## LEASING ENQUIRIES

**CHRIS ALCOCK** YFG Portfolio Leasing Manager  
Toowong Village & Tower  
P 3323 8888 | M 0401 237 817  
E [chris.alcock@retailfirst.com.au](mailto:chris.alcock@retailfirst.com.au)

**KERRI JONES** Centre Manager  
Toowong Village & Tower  
P 07 3870 7177  
E [kjones@retailfirst.com.au](mailto:kjones@retailfirst.com.au)

Retail First

9 SHERWOOD RD, TOOWONG QLD 4066 | P (07) 3870 7177  
TOOWONGVILLAGE@RETAILFIRST.COM.AU | WWW.TOOWONGVILLAGE.COM.AU

**Disclaimer:** The shopping centre described in this publication is managed by Retail First Pty Ltd. Whilst all reasonable efforts have been made to ensure the information in this publication is accurate and up to date, Retail First maintains the right to update or change the information at any time, without notice to users. Retail First does not warrant the content or accuracy of the information in this publication, including information sourced from third parties, and does not guarantee that any forward looking statement, image, artist impression, or forecast in this publication will actually occur. Retail First has taken all reasonable care when preparing this publication but accepts no liability from the use or reliance of the information. This publication was created in July 2022. ABS Census data 2016.

